



PERFECT DIALOGUE



THE PRODUCT

You can hardly present your communication or network systems in a more attractive way.

The DIATEC is an attractive eye-catcher in your direct living and working environment. But this innovative range of cases also offers many functional benefits.

All details are designed to match each other perfectly. Depending on requirements, different equipment options and connections are possible.

YOUR ADVANTAGE

Modern, flat enclosure design, ideal for table top and wall mounting applications.

Plain, recessed area on the bottom part for installation and protection of interfaces, screwed cable glands, plug-in connections etc.

Easy, flush wall mounting.

Recessed operating area for the protection of the membrane keyboards and operating elements.

Protection class IP 40

Max. size of PCB (L x W in mm)

	bottom part	top part
XS	120 x 115	127 x 115
S	120 x 180	120 x 180
M	180 x 180	180 x 180
L	240 x 180	240 x 180

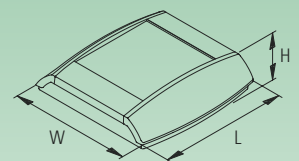

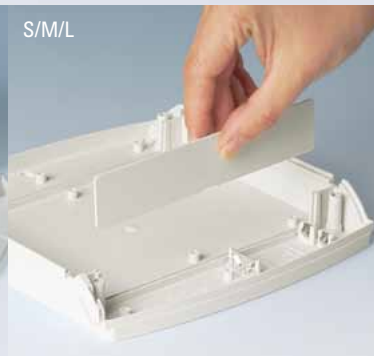

S/M/L

NEW
XS

S/M/L

S/M/L

PRESTIGIOUS

Design DIATEC XS

Two-piece case, consisting of top and bottom part, screwed together. Integrated battery holder for 2 x 1.5 V AA batteries. Pre-shaped flush-mounting box contoured in the bottom part.

DIATEC S, M, L

Four-piece case, consisting of top and bottom part as well as two covers for concealing the assembly screws. If required, the snap-on covers can be locked to prevent unauthorised access. Integrated battery compartment for 2 x 1.5 V AA batteries or 1 x 9 V flat battery.

SPEZIAL FOR S/M/L

Separate slot-in panels can be used as interior partitions, for example to guard the electronics when changing batteries. This allows the complete pre-assembly of the electronics unit. The technician on site only has to mount the unit on the wall and connect up the relevant leads. Connection can be effected from the left and/or from the right-hand side. The actual case does not have to be opened to do this, only the snap-on side trims.

Hinged lid in case colour or transparent for covering the dialogue zone as accessory.

APPLICATIONS

Systems for data collection on the job.

Access and security controls.

Peripheral equipment for computers, data system engineering.

Measuring and controlling.

Medical field and laboratory technology.

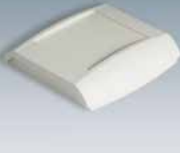

DIATEC

Enclosure	Size	Outside dim. in mm			Equipment (dim. in mm) max. dim. keypad	Material	Part-No.	
		L	W	H			off-white RAL 9002	lava NCS S 7502-B
	XS* ¹ NEW	155	150	37		ABS (UL 94 HB)	A 90 92 107	A 90 92 108
	S* ²	200	210	48	127.60 x 119.70	ABS (UL 94 HB)	A 90 93 107	A 90 93 108
	M* ²	200	270	48	127.60 x 179.60	ABS (UL 94 HB)	A 90 94 107	A 90 94 108
	L* ² NEW	200	330	48		ABS (UL 94 HB)	A 90 95 107	A 90 95 108

DIATEC ACCESSORIES

Article	For DIATEC	Version / Application	ABS, case colour* ³	Part-No.	
				PC, translucent* ⁴	PC, clear* ⁴
① Klappe	S, L (off-white)* ⁵	2 mounting holes \varnothing 4.2 mm necessary, 1 set	A 91 93 127	A 91 93 121	A 91 93 131
	S, L (lava)* ⁵	2 mounting holes \varnothing 4.2 mm necessary, 1 set	A 91 93 128	A 91 93 122	A 91 93 132
	M (off-white)	2 mounting holes \varnothing 4.2 mm necessary, 1 set	A 91 94 127	A 91 94 121	A 91 94 131
	M (lava)	2 mounting holes \varnothing 4.2 mm necessary, 1 set	A 91 94 128	A 91 94 122	A 91 94 132

Article	For DIATEC	Version / Application	Part-No.
② Slot-in panel	S, M, L	ABS, off-white, 156 x 30 x 3 mm, 1 pc	A 91 94 007
③ Set of battery clips NEW	XS	nickel-plated for 2 x 1.5 V mignon cells (AA)	A 91 90 015
	S, M, L	tin-plated for 2 x 1.5 V mignon cells (AA)	A 91 90 002
④ Plug-in contact	S, M, L	for one 9 V flat battery (PP3), 1 pc	A 91 60 003
⑤ Non-slip pads	XS	transparent, self-adhesive, ensure reliable desk-top positioning, 1 pair	A 92 07 150
	S, M, L	transparent, self-adhesive, ensure reliable desk-top positioning, 1 pair	A 92 12 330
⑥ Self-tapping screw	XS, S, M, L	\varnothing 3 x 6 mm (PZ1), for mounting PCBs, 1 pc	A 03 06 031
⑦ Torx screwdriver T10 NEW	XS	Torx 10, with ergonomic handle, for assembling enclosure	A 03 99 T10

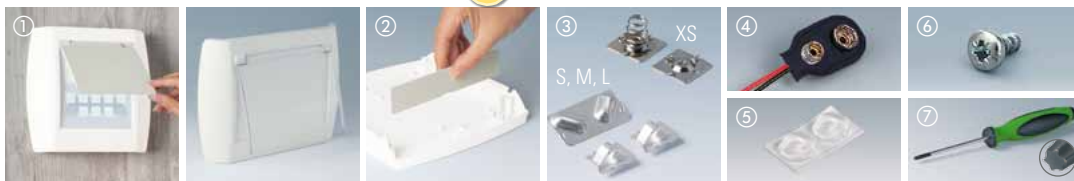

UNIVERSAL ACCESSORIES

Self-tapping screw	Version / Application	Part-No.
	\varnothing 3 x 8 mm (Torx 10), stainless steel, 1 pc As an alternative to A 03 08 031 (self-tapping screw \varnothing 3 x 8 mm with cross recess PZ1) for PCB mounting – for information on which screw diameter matches which OKW case, please refer to www.okw.com . Or as a substitute for case assembly DIATEC XS (2 pcs. required).	NEW A 03 08 132

*¹ Supply: 1 bottom and top part each, assembly kit.

Assembly of bottom and top part with 2 Torx T10 self-tapping screws, stainless steel.

*² Supply: 1 bottom and top part each, 1 trim left and right side incl. 2 locking elements, assembly kit.

Assembly of top and bottom part with 4 self-tapping screws (PZ2), snap-on side trims. If required, the trims can also be locked, thus preventing unauthorised access.

*³ in the relevant case colour*⁴ fasteners from the assembly set in the case colour in question*⁵ hinged lid for covering the dialogue area of the DIATEC S or for partially covering the dialogue area of the DIATEC L (half side)